



IS 778 Cu-ALLOY HORIZONTAL LIFT CHECK VALVES IS: 778

SPECIFICATIONS

SCREWED IN COVER, INTEGRAL SEAT, SCREWED FEMALE THREADS TO IS : 554 (PARALLEL)

PRESSURE TEMPERATURE RATING :

Class 1- 1.0 Mpa upto 45°C
Class 2 - 1.6 Mpa up to 45°C

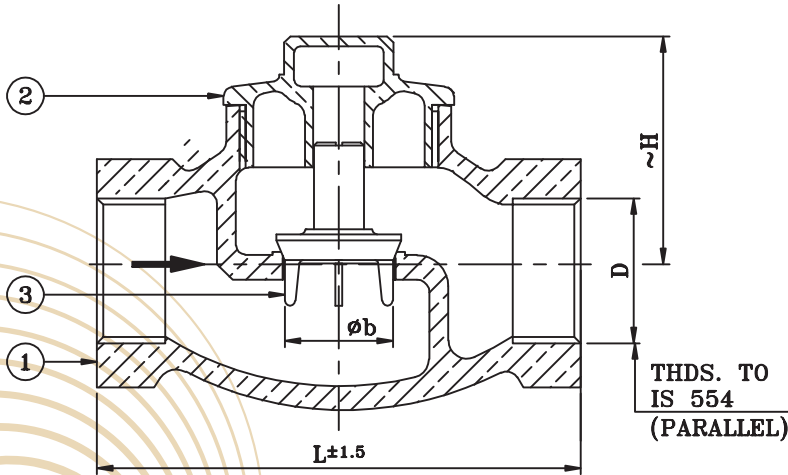

STANDARD MATERIAL COMBINATION

P. NO.	DESCRIPTION	MATERIALS	SPECIFICATIONS
1.	BODY	LEADED TIN BRONZE	IS 318 LTB2
2.	COVER	LEADED TIN BRONZE	IS 318 LTB2
3.	DISC	LEADED TIN BRONZE	IS 318 LTB2

DIMENSIONAL DATA

SIZE (mm)	8	10	15	20	25	32	40	50	65	80	100	
L	40	40	60	70	80	95	110	125	160	180	216	
L1	-	-	24	31	35	43	48	58	70	81	112	
Øb	9.5	9.5	15	20	25	32	40	50	65	80	100	
H	23	23	36	44	51	54	63	70	88	94	118	
H1	-	-	25	30	40	45	50	65	90	55	110	
ITEM CODE	CLASS-1	IS 021	IS 021	IS 021	IS 021	IS 021	IS 021	IS 021	IS 021	IS 021	IS 021	IS 021
Aprox. Wt. ^	----	----	0.320	0.750	0.790	1.155	1.495	2.395	4.300	6.385	11.890	
ITEM CODE	CLASS-2	IS 023	IS 023	IS 023	IS 023	IS 023	IS 023	IS 023	IS 023	IS 023	IS 023	IS 023
Aprox. Wt. ^	----	----	0.380	0.790	0.965	1.260	1.910	2.815	4.565	6.720	12.490	

TEST PRESSURES

NOMINAL PRESSURE ACCORDING TO CLASS DESIGNATION	SHELL TEST (HYDROSTATIC)	SEAT & BACK SEAT (HYDROSTATIC)	STANDARD NO.
CLASS 1	1.5 Mpa (217.5 psig)	1.0 Mpa (145 psig)	IS 6157
CLASS 2	2.4 Mpa (348 psig)	1.6 MPA (232 psig)	

NOTE: The above data is subject to change without notice due to our continuing product improvement program. (^WEIGHT GIVEN IN KGS)